

Peristaltic Pumps

These small peristaltic pumps are designed for panel mounting or incorporation into any machine that needs an accurate, low maintenance dosing solution. A flexible pump design for intermittent & specialty pump applications. These self priming peristaltic pumps are able to perform variable flow, reversible, chemical resistant and can handle particulates & viscous fluids easily.

These small peristaltic pumps are among the smallest in the market & are a great low cost alternative. Flow ranges from 1.0 mL/min to 320 mL/min.

FEATURES

- ✓ 3 Rollers or 6 Rollers
- ✓ Clockwise & Counter-Clockwise Rotation
- ✓ Highly Stable
- ✓ Changeable Tubing
- ✓ Tubing Options: High-Grade Viton (V), PharMed® BPT (BPT), Norprene® (N), Silicone (S)



MP-1

Flow Rate: up to 2.0 mL/min
Size: 35 mm x 17 mm x 14 mm
Weighs only 13 gms



SP-1

Flow Rate: up to 30 mL/min
Size: 55 mm x 30 mm x 25 mm
Weighs only 45 gms



PP-1

Flow Rate: up to 95 mL/min
Gear Drive, DC Standard Motor
Viscous Fluid



PP-1-BL (brushless)

Flow Rate: up to 130 mL/min
Gear Drive, DC Brushless Motor
Viscous Fluid

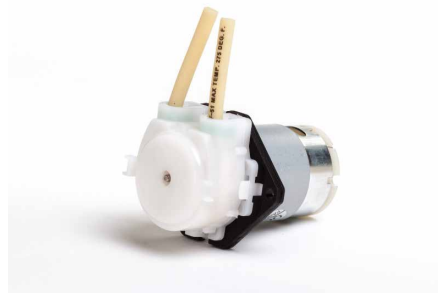

PP-2

Flow Rate: up to 90 mL/min
Low Cost
OEM Applications



PP-3-BL

Flow Rate: up to 320 mL/min
Brushless DC Motor
3 Rollers

Peristaltic Pumps (continued)

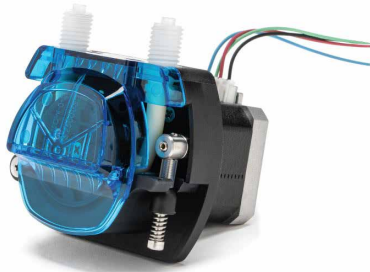
**PP-4**

Flow Rate: up to 300 mL/min
Stepper Motor
Viscous Fluid

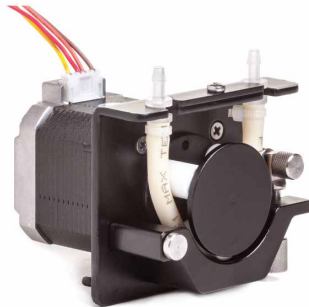
**PP-5**

Flow Rate: up to 300 mL/min
Stepper Motor
Viscous Fluid

**PP-6**

Flow Rate: up to 600 mL/min
Stepper Motor
Viscous Fluid

**PP-7**

Flow Rate: up to 72 mL/min
Stepper Motor
3 Rollers

**PP-7 mini**

Flow Rate: up to 50 mL/min
Stepper Motor
6 Rollers

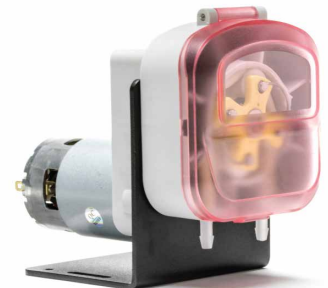
**PP-8**

Flow Rate: up to 280 mL/min
DC Motor
Viscous Fluid

**PP-9**

Flow Rate: up to 300 mL/min
Stepper Motor
Viscous Fluid

**PP-10**

Flow Rate: up to 1,500 mL/min
DC or Stepper Motor
Quick Tube Change

Peristaltic Pumps (continued)



PP-202 Series

Max Flow Rate: 800 mL/min
Speed up to 350 rpm



PP-303 Series

Flow Rate: Up to 1330 mL/min
Speed up to 350 rpm



PP-404 Series

Max. Flow Rate: 40 mL/min
Speed up to 100 rpm



PP-606 Series

Max. Flow Rate: 365 mL/min
Speed up to 300 rpm
Single or Dual Channel

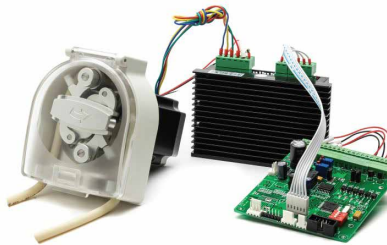

PP-707 Series

Flow Rate: Up to 6663 mL/min
Speed up to 600 rpm



PP-808 Series

Flow Rate: Up to 250 mL/min
(continuous)
Flow Rate: Up to 495 mL/min
(intermittent)



PP-909 Series

Max. Flow Rate: 2,200 mL/min
Speed up to 600 rpm
Unique flip-top pump head for quick tube change

MP-1 Micro Peristaltic Pump



TECHNICAL DETAILS

- ✓ Max. Flow Rate: 2.0 mL/min
- ✓ Tubing: 2.5 m OD
- ✓ Tubing Material: Silicone or Norprene
- ✓ Voltage: 3.7 V
- ✓ Weight: 13 gms.
- ✓ Dimensions: 35 mm x 17 mm x 14 mm

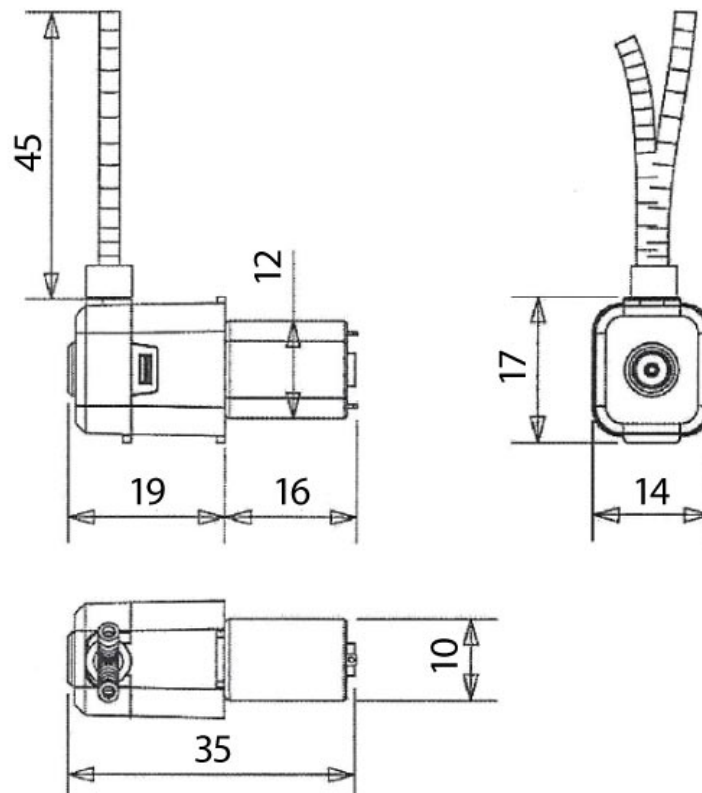

SP-1 Peristaltic Pump

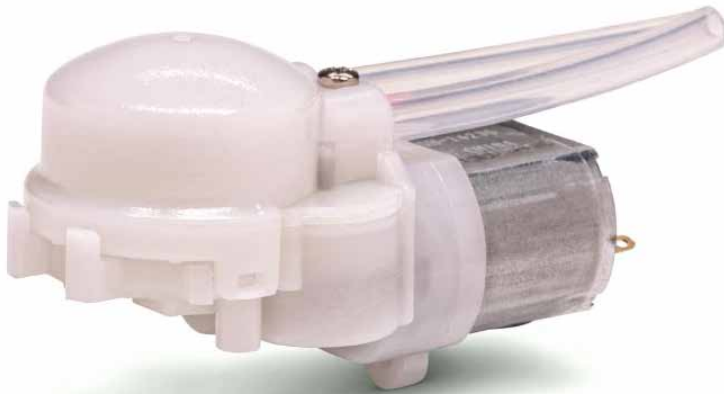

TECHNICAL DETAILS

- ✓ Max. Flow Rate: 30 mL/min
- ✓ Tubing: 2.0 mm ID x 4.0 mm OD / 3.0 mm ID x 5.0 mm OD
- ✓ Tubing Material: Silicone or PharMed BPT
- ✓ Voltage: 6 V/ 12 V
- ✓ Weight: 45 gms.
- ✓ Dimensions: 55 mm x 30 mm x 25 mm

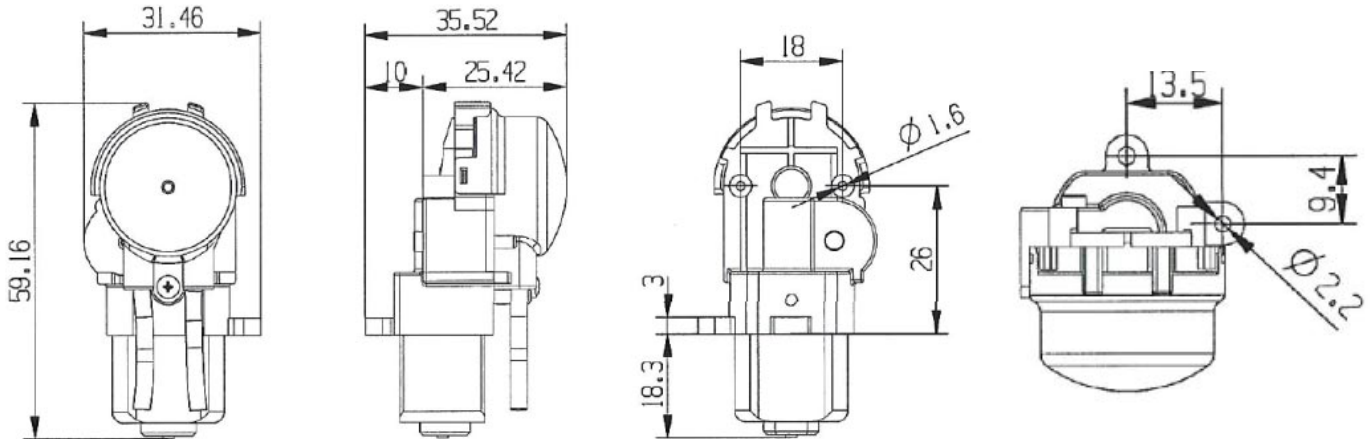

SP-1	Flow Rate (mL/min)		
12 VDC	3	10	10
Tubing Options			
Tubing Material	S	S	BPT
Tubing Size IDxOD (mm)	1x3	2x4	2x4



PP-1 Peristaltic Pump



FEATURES

- ✓ Compact Size
- ✓ Light Weight: 90 gms
- ✓ Flow Rate: 1 mL/min to 95 mL/min range
- ✓ Suitable for viscous and non-viscous liquids
- ✓ Tubing Options: High-Grade Viton (V), PharMed® BPT (BPT), Silicone (S)
- ✓ Special gear system design eliminates slippage problem very common in other peristaltic pumps
- ✓ Available in 2 different Gear Down Ratio options - enables operating at very low flow rates
- ✓ Also available with Brushless DC Motor with PWM for precise control of the pump output

One Slowdown Gear

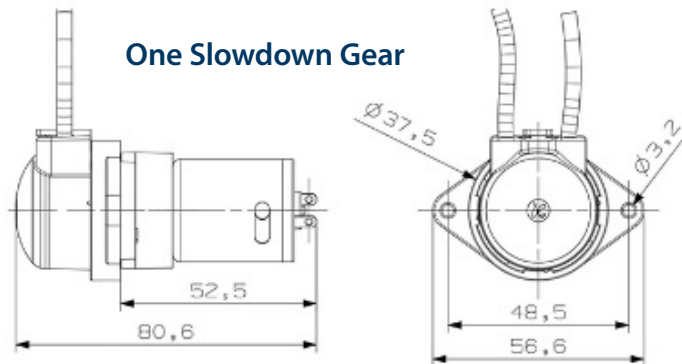

Two Slowdown Gear

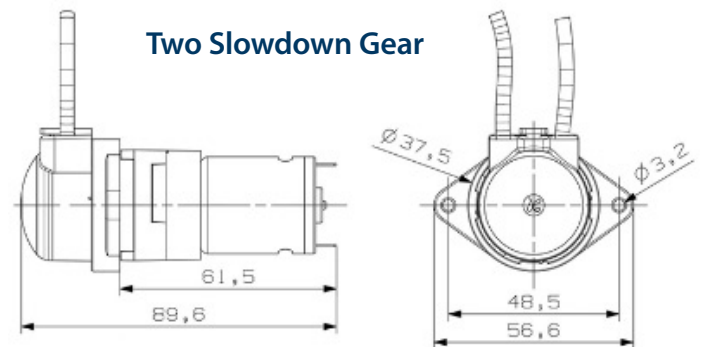

PP-1	Flow Rate (mL/min)						
6 VDC (600 mA) One Gear Down	15	50	95	15	50	95	70
6 VDC (600 mA) Two Gear Down	1	4	7	1	4	7	6
12 VDC (400 mA) One Gear Down	15	50	95	15	50	95	70
12 VDC (400 mA) Two Gear Down	1	4	7	1	4	7	6
24 VDC (200 mA) One Gear Down	15	50	95	15	50	95	70
24 VDC (200 mA) Two Gear Down	1	4	7	1	4	7	6
Tubing Options							
Tubing Material	S	S	S	BPT	BPT	BPT	V
Tubing Size IDxOD (mm)	1x3.3	2x4	3x5	1x3.3	2x4	3x5	2.5x4.2

PP-1-BL (brushless) Peristaltic Pump



FEATURES

- ✓ Compact Size
- ✓ Light Weight: 90 gms
- ✓ Flow Rate: 1 mL/min to 130 mL/min range
- ✓ Suitable for viscous and non-viscous liquids
- ✓ Tubing Options: High-Grade Viton (V), PharMed® BPT (BPT), Silicone (S)
- ✓ Special gear system design eliminates slippage problem very common in other peristaltic pumps
- ✓ Available in 2 different Gear Down Ratio options - enables operating at very low flow rates
- ✓ Brushless DC Motor with PWM for precise control of the pump output

WIRING INSTRUCTIONS FOR BRUSHLESS MOTOR:

RED: +ve

BLACK: -ve

BLUE: PWM (Pulse Width Modulation) 5-20 kHz, 0-5 V

GREEN: Motor speed feedback

YELLOW: CW/CCW

* Black & Blue wires may be joined together if PWM function is not needed.

One Gear Down

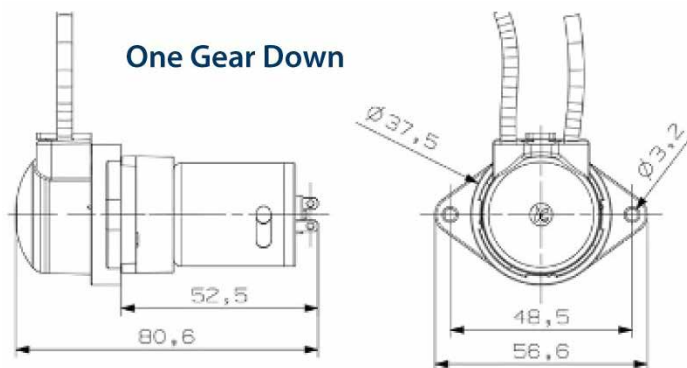

Two Gear Down

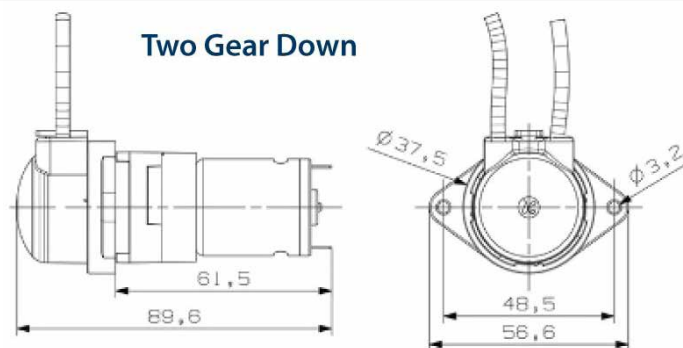

PP-1-BL	Flow Rate (mL/min)						
12 VDC (400 mA) One Gear Down	15	65	120	20	60	130	70
12 VDC (400 mA) Two Gear Down	1	5	10	2	6	9	6
24 VDC (200 mA) One Gear Down	15	65	120	20	60	130	70
24 VDC (200 mA) Two Gear Down	1	5	10	2	6	9	6
Tubing Options							
Tubing Material	S	S	S	BPT	BPT	BPT	V
Tubing Size IDxOD (mm)	1x3.3	2x4	3x5	1x3.3	2x4	3x5	2.5x4.2

PP-2 Peristaltic Pump



FEATURES

- ✓ Small Size
- ✓ Flow Rate: 1 mL/min to 90 mL/min range
- ✓ Low power consumption
- ✓ Suitable for intermittent operation
- ✓ Two different mounting configurations to choose from
- ✓ PharMed® BPT (BPT) tubing has better chemical resistance than Silicone (S) and meets USP Class Vi, FDA, NSF criteria

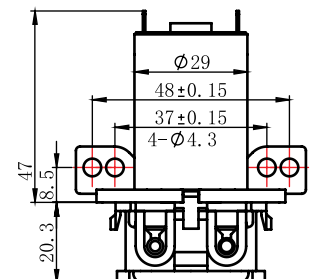
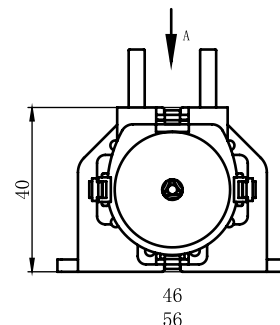
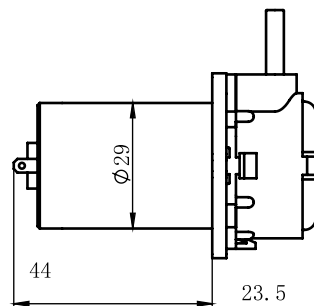
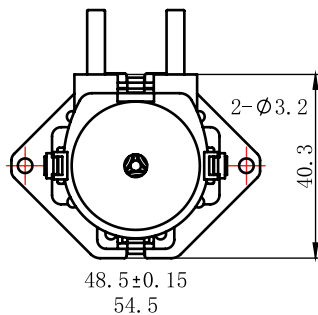

PP-2	Flow Rate (mL/min)										
3 VDC	1	3	4	10	18	30	40	5	12	15	20
6 VDC	3	5	10	22	35	60	90	10	25	40	50
12 VDC	3	5	10	22	35	55	80	10	22	35	45
24 VDC	2	4	10	22	35	60	85	10	22	35	50
Tubing Options											
Tubing Material	S	S	S	S	S	S	S	BPT	BPT	BPT	BPT
Tubing Size IDxOD (mm)	0.4x3	0.6x3	1x3.3	1.5x4	2x4	2.5x4.5	3x5	1x3.3	2x4	2.5x4.5	1.5x3.5

PP-3-BL (brushless) Peristaltic Pump



FEATURES

- ✓ Compact Size
- ✓ Lightweight: 170 gms
- ✓ Flow Rate: 320 mL/min max
- ✓ Max Speed: 450 rpm (intermittent)
- ✓ Suitable for viscous and non-viscous liquids
- ✓ Tubing Options: Norprene (N), Silicone (S)
- ✓ Special gear system design eliminates slippage problem very common in other peristaltic pumps
- ✓ Brushless DC Motor with PWM (Pulse Width Modulation) capability for precise control of the pump output
- ✓ 3 Rollers
- ✓ Dimensions (mm): 101x54x55

WIRING INSTRUCTIONS FOR BRUSHLESS MOTOR:

RED: +ve

BLACK: -ve

WHITE: PWM (Pulse Width Modulation) 5-20 kHz, 0-5 V

YELLOW: Motor speed feedback

GREEN: CW/CCW

* Red & White wires may be joined together if PWM function is not needed.

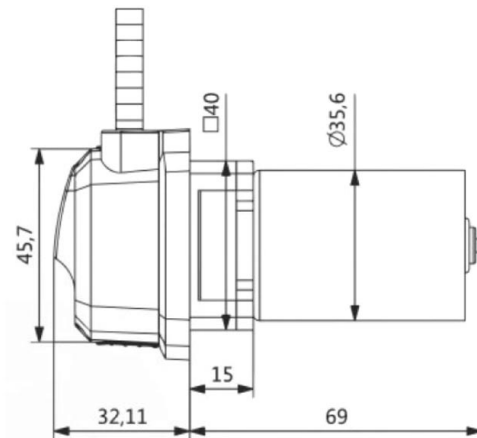
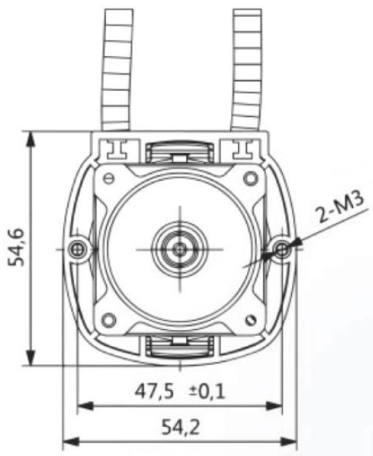

PP-3-BL	Flow Rate (mL/min)			
12 VDC (800 mA) One Gear Down	210	320	200	300
24 VDC (400 mA) One Gear Down	210	320	200	300
Tubing Options				
Tubing Material	S 16	S 40	N 16	N 40
Tubing Size IDxOD (mm)	3.2x6.4	4.0x7.2	3.2x6.4	4.0x7.2

PP-4 Peristaltic Pump

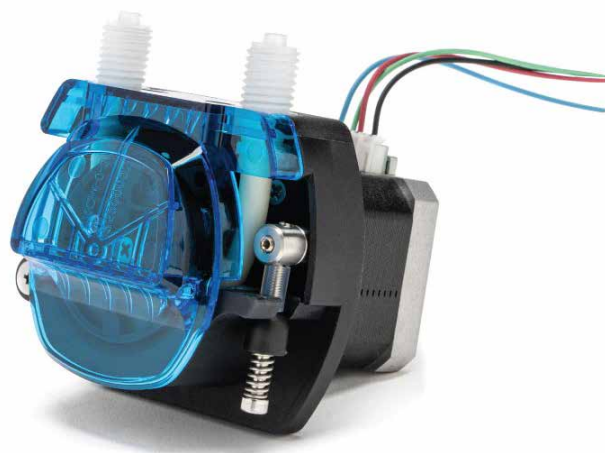

FEATURES

- ✓ Flow Rate: up to 300 mL/min
- ✓ Max Motor Speed: 450 rpm (24V) / 350 rpm (12V)
- ✓ Tubing wall thickness up to 1.6 mm for high performance
- ✓ Stepper Motor for quiet operation
- ✓ Tubing Options: PharMed® BPT (BPT), Silicone (S), Norprene® (N)
- ✓ Choice of 3 rollers or 6 rollers for higher precision
- ✓ Weight (gms): 425
- ✓ Dimensions (mm): 88x74x79

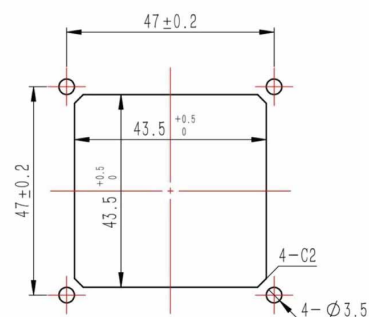
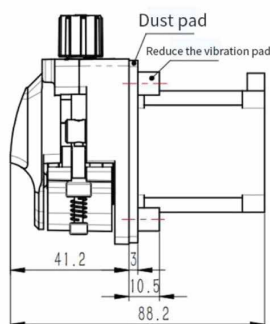
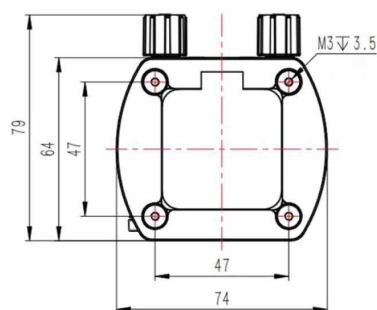

PP-4	Flow Rate (mL/min)				
12 VDC – 3 Rollers	16	45	100	125	240
12 VDC – 6 Rollers	13	40	75	90	125
24 VDC – 3 Rollers	18	55	130	170	300
24 VDC – 6 Rollers	15	40	95	120	170
Tubing Options					
Tubing Code	S 13	S 14 / BPT / N	S 19 / BPT	S 16 / BPT / N	S 40
Tubing Size IDxOD (mm)	0.8x4	1.6x4.8	2.4x5.6	3.2x6.4	4x7.2

PP-5 Peristaltic Pump (stepper motor)



FEATURES

- ✓ Flow Rate: up to 300 mL/min
- ✓ Tubing wall thickness up to 1.6 mm for high performance
- ✓ Stepper Motor allows for quiet operation (see PP-4 for DC Motor option)
- ✓ Tubing Options: High-Grade Viton (V), PharMed® BPT (BPT), Norprene® (N), Silicone (S)
- ✓ Max Motor Speed: 450 rpm
- ✓ Choice of 3 rollers or 6 rollers for higher precision

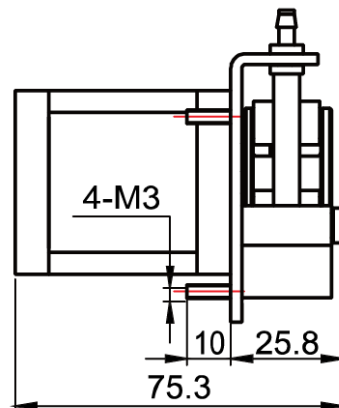
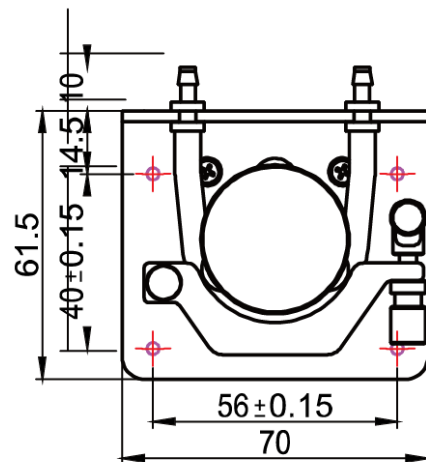

PP-5	Flow Rate (mL/min)							
12 VDC Stepper - 3 Rollers	18	55	120	170	300	30	70	90
12 VDC Stepper - 6 Rollers	15	45	95	135	200	--	--	--
24 VDC Stepper - 3 Rollers	18	55	120	170	300	45	100	130
24 VDC Stepper - 6 Rollers	15	45	95	135	200	--	--	--
Tubing Options								
Tubing Material	S	S / BPT / N	S / BPT	S / BPT / N	S	V	V	V
Tubing Size IDxOD (mm)	0.8x4	1.5x5	2.5x6	3x6	4x7	1.7x3.5	2.5x4.2	2.8x4.5

PP-6 Peristaltic Pump (stepper motor)



FEATURES

- ✓ Flow Rate: up to 600 mL/min
- ✓ Suitable for viscous and non-viscous liquids
- ✓ Stepper Motor for quiet operation (24V, 1.5A)
- ✓ Tubing Options: PharMed® BPT (BPT), Silicone (S)
- ✓ Max Motor Speed: 500 rpm
- ✓ 3 Rollers
- ✓ Weight (gms): 450
- ✓ Dimensions (mm): 85x63x63

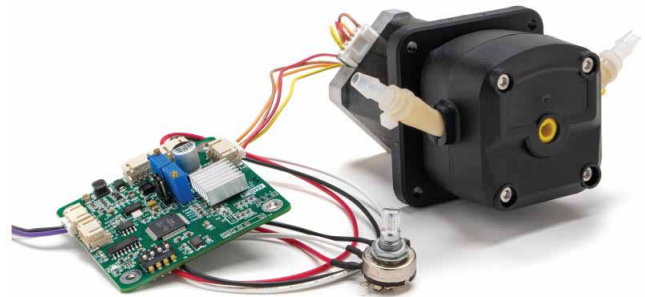
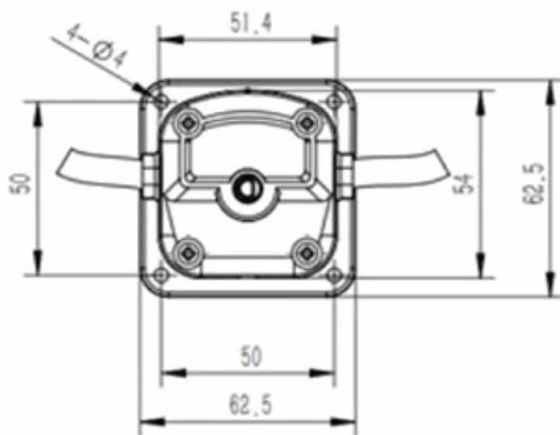

PP-6	Flow Rate (mL/min)	
24 VDC – 3 Rollers	540	600
Tubing Options		
Tubing Code	B 25	S 28
Tubing Size IDxOD (mm)	4.8x8.0	5.0x8.2

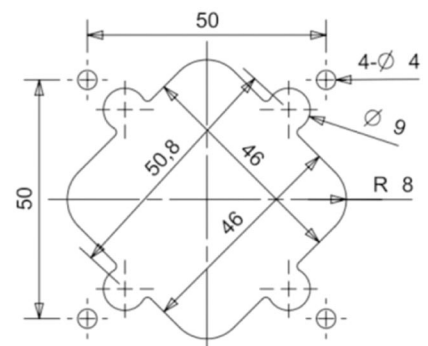
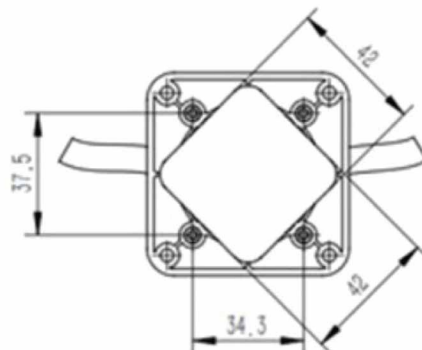
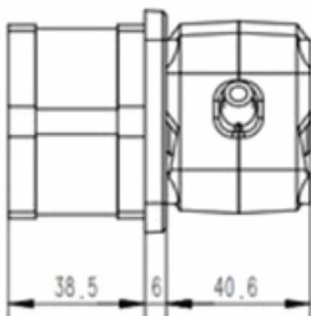

PP-7 Peristaltic Pump (3 Rollers)



FEATURES

- ✓ Flow Rate: up to 72 mL/min
- ✓ Stepper Motor allows for quiet operation and is more precise than DC Motor
- ✓ Tubing Options: PharMed® BPT (BPT), Silicone (S)
- ✓ Max Motor Speed: 250 rpm
- ✓ 3 Rollers

WIRING INSTRUCTIONS: (2 Options)

Phase A	Brown A+	Phase A	Black A+
	Orange A-		Green A-
Phase B	Red B+	Phase B	Red B+
	Yellow B-		Blue B-

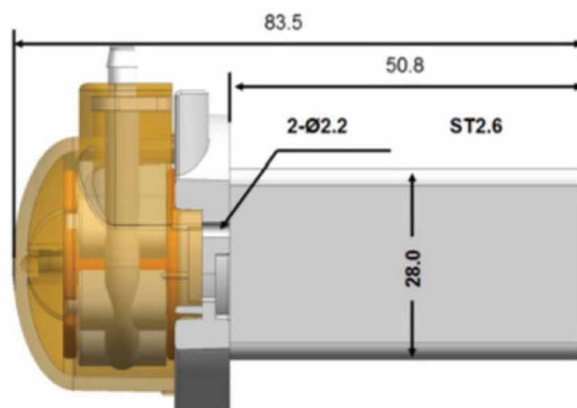
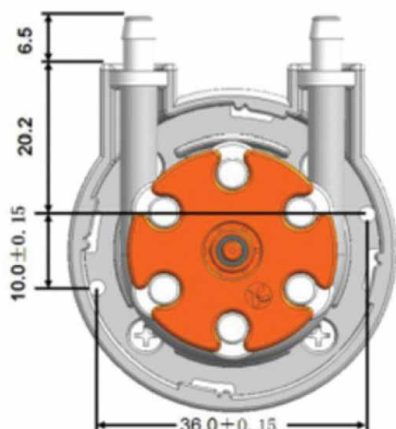

PP-7	Flow Rate (mL/min)					
12 VDC Stepper - 3 Rollers	12	27	45	72	12	25
24 VDC Stepper - 3 Rollers	12	27	45	72	12	25
Tubing Options						
Tubing Material	S	S / BPT	S / BPT	S	BPT	BPT
Tubing Size IDxOD (mm)	1x3	2x4	2.5x4.5	3x5	1x3.2	1.5x3.5

PP-7mini Peristaltic Pump (6 Rollers)



FEATURES

- ✓ Flow Rate: up to 50 mL/min
- ✓ Stepper Motor allows for quiet operation and is more precise than DC Motor
- ✓ Tubing Options: PharMed® BPT (BPT), Silicone (S)
- ✓ Max Motor Speed: 350 rpm
- ✓ 6 Rollers

WIRING INSTRUCTIONS: (2 Options)

Phase A	Brown A+	Phase A	Black A+
	Orange A-		Green A-
Phase B	Red B+	Phase B	Red B+
	Yellow B-		Blue B-

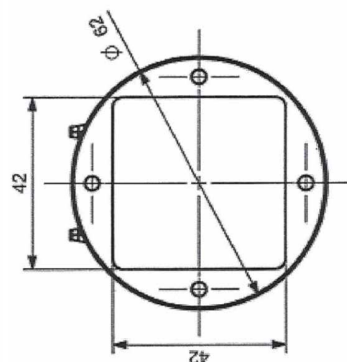
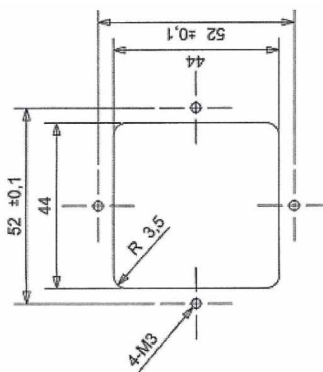
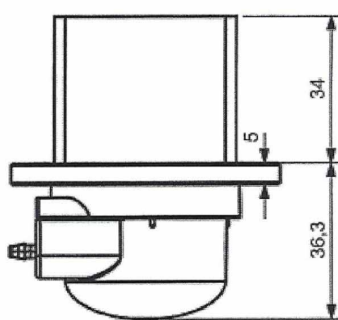
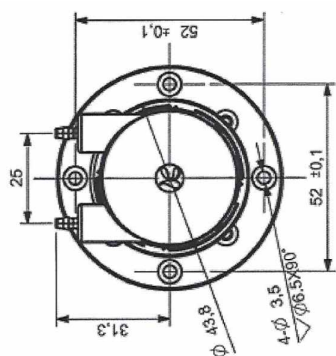

PP-7mini	Flow Rate (mL/min)		
12 VDC Stepper - 6 Rollers	30	40	50
24 VDC Stepper - 6 Rollers	30	40	50
Tubing Options			
Tubing Material	S / BPT	S / BPT	S / BPT
Tubing Size IDxOD (mm)	2x4	2.5x4.5	3x5

PP-8 Peristaltic Pump



FEATURES

- ✓ Designed for higher flow applications
- ✓ Flow Rate: up to 280 mL/min
- ✓ Suitable for viscous and non-viscous liquids, as well as handling liquids with particles
- ✓ Choice of DC Motor or Stepper Motor for precise control (see PP-9 for Stepper Motor option)
- ✓ Thick wall tubing for long life and tubing materials provide for good chemical resistance
- ✓ Tubing Options: PharMed® BPT (BPT) and Norprene® (N)
- ✓ 4 rollers for higher precision (Optional)

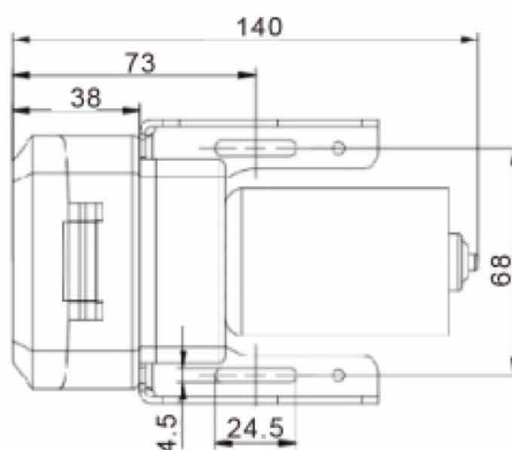
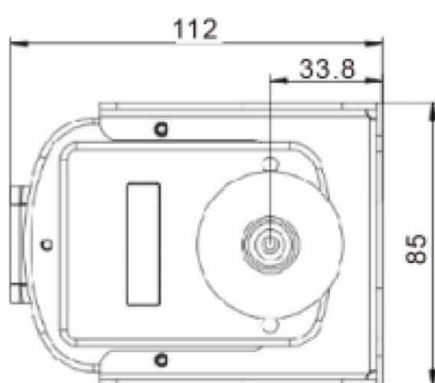

PP-8	Flow Rate (mL/min)		Speed (RPM)	Weight (lbs.)
DC Motor 12 VDC (0.5 A)	280	280	300	1.6
DC Motor 24 VDC (0.28 A)	280	280	300	1.6
Tubing Options				
Tubing Material	BPT	Norprene	---	---
Tubing Size IDxOD (mm)	4x7.2	4x7.2	---	---

PP-9 Peristaltic Pump

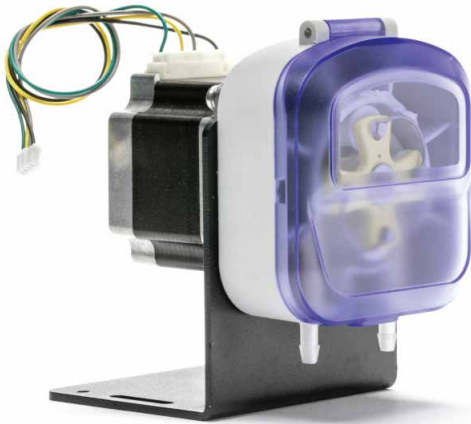

FEATURES

- ✓ Designed for higher flow applications
- ✓ Flow Rate: up to 300 mL/min
- ✓ Suitable for viscous and non-viscous liquids, as well as handling liquids with particles
- ✓ Choice of DC Motor or Stepper Motor for precise control (see PP-8 for DC Motor option)
- ✓ Thick wall tubing for long life and tubing materials provide for good chemical resistance
- ✓ Tubing Options: PharMed® BPT (BPT) and Norprene® (N)
- ✓ 4 rollers for higher precision (Optional)

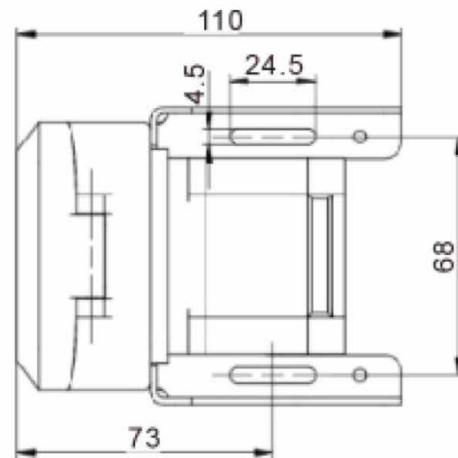
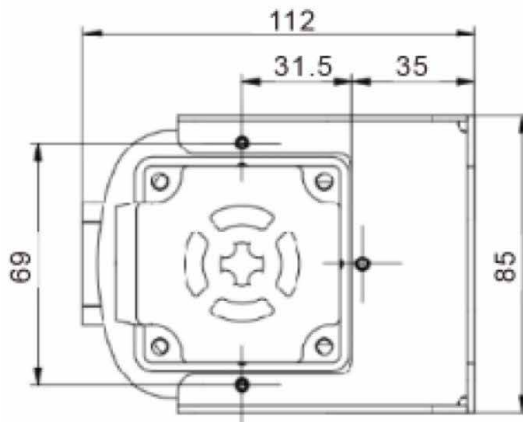

PP-9	Flow Rate (mL/min)		Speed (RPM)	Weight (lbs.)
Stepper Motor 12 VDC (1.8 A)	5-300 (400 RPM)	5-300 (400 RPM)	1-500	3.2
Stepper Motor 24 VDC (0.9 A)	5-300 (400 RPM)	5-300 (400 RPM)	1-500	3.2
Tubing Options				
Tubing Material	BPT	Norprene	---	---
Tubing Size IDxOD (mm)	4x7.2	4x7.2	---	---

PP-10 Peristaltic Pump

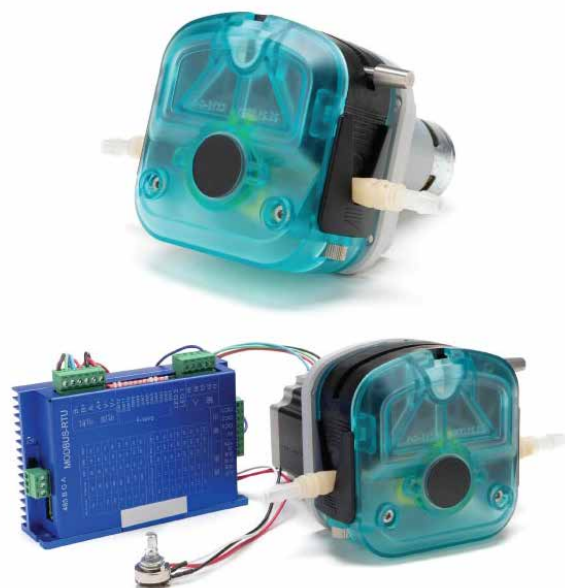

FEATURES

- ✓ Flow Rate: up to 1,500 mL/min
- ✓ Suitable for OEM applications
- ✓ Quick tube changes
- ✓ Choice of DC Motor or Stepper Motor for quiet operation
- ✓ Tubing Options: PharMed® BPT (BPT), Silicone (S), Norprene® (N)
- ✓ Max Motor Speed: 350 rpm
- ✓ 3 Rollers
- ✓ MODBUS Controller for Stepper Motor (optional)

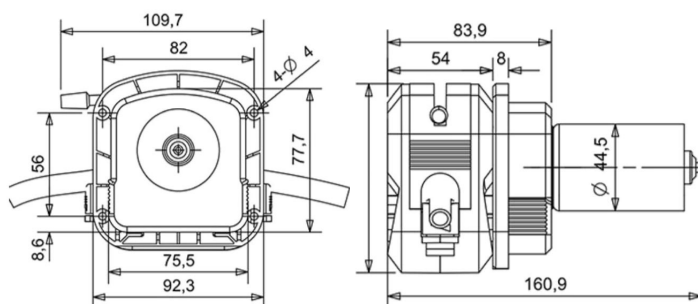

PP-10-DC Technical Drawings

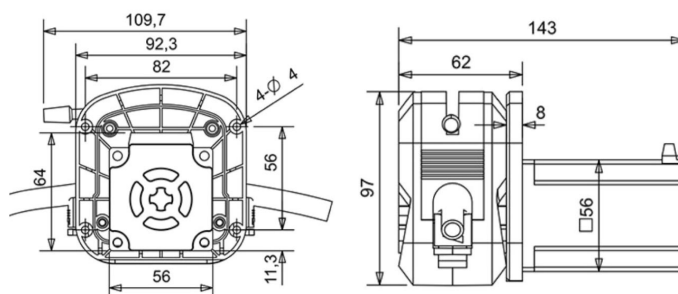

PP-10-ST Technical Drawings

PP-10	Flow Rate (mL/min)						
12 VDC – DC Motor (1.2A) 3 Rollers	400	570	900	1,240	410	560	800
24 VDC – DC Motor (0.6A) 3 Rollers	440	600	1,000	1,300	440	600	860
24 VDC – Stepper Motor (1.8A) 3 Rollers	420	650	1,100	1,500	420	650	1,000
Tubing Options							
Tubing Code	S 40	S 25	S 17	S 18	B 40	B 25	B 17
Tubing Size IDxOD (mm)	4.0x7.2	4.8x8.0	6.4x9.6	7.9x11.1	4.0x7.2	4.8x8.0	6.4x9.6



OEM PUMPS PP-202 SERIES

FEATURES

- ✓ Miniature Peristaltic Pumps for OEM applications
- ✓ Compact design
- ✓ Flow rate up to 800mL/min
- ✓ Complete range of Drives: Stepper motor, DC motor, Brushless DC motor & AC motor
- ✓ See through protective shield made of strong Polyethersulfone (PES)
- ✓ Available in different colors to differentiate between different types of fluids

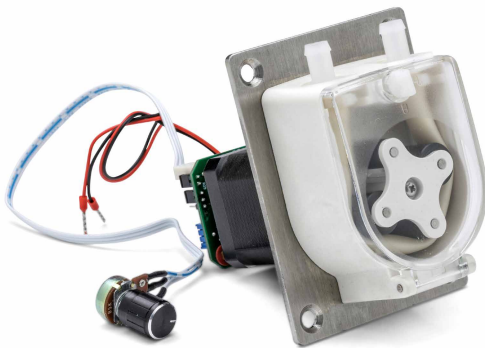

PP-202-SM



PP-202-SM-DCDR (With Controller)



PP-202-DC

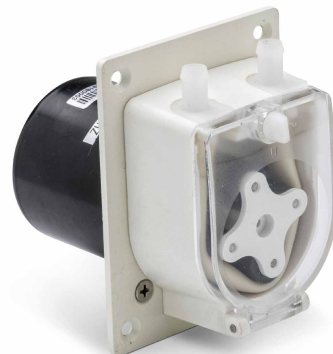

PP-202-AC

PP-202-SM

Precision Peristaltic Pump

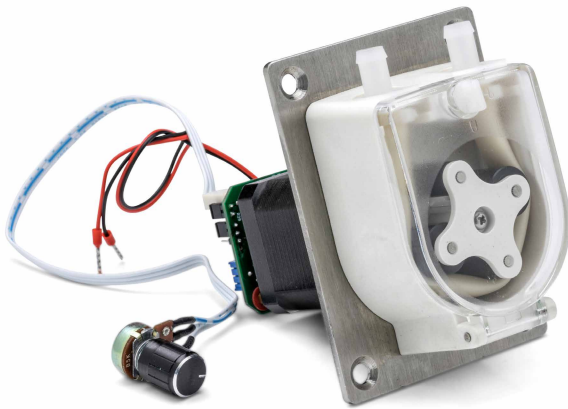

PP202-SM Pump Details

Speed Range	≤ 300rpm
Max. Flow Rate	800mL/min
Motor Type	42 Stepper Motor
Motor Phase Number	2
Motor Step Angle	1.8°
Motor Phase Voltage	3.0V
Motor Phase Current	3.0A

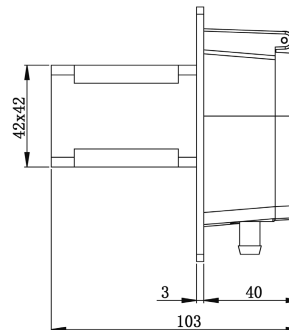
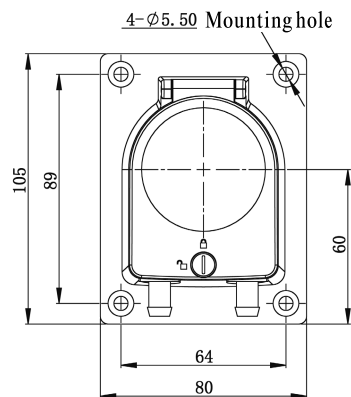

PP-202-SM-DCDR (With Controller)

Precision Peristaltic Pump

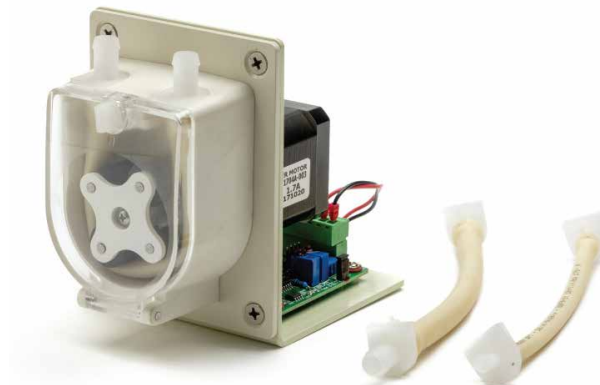

PP-202-DC

Precision Peristaltic Pump

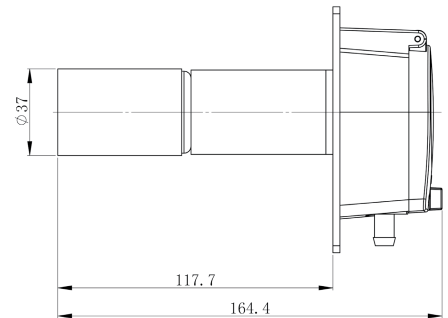
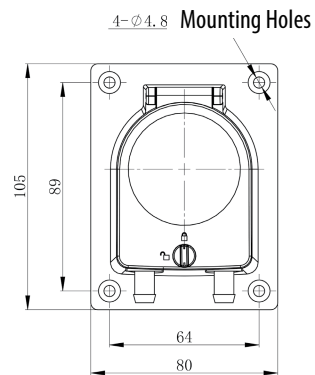

PP-202-AC

Precision Peristaltic Pump

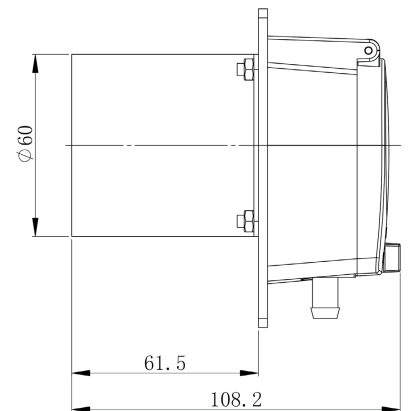
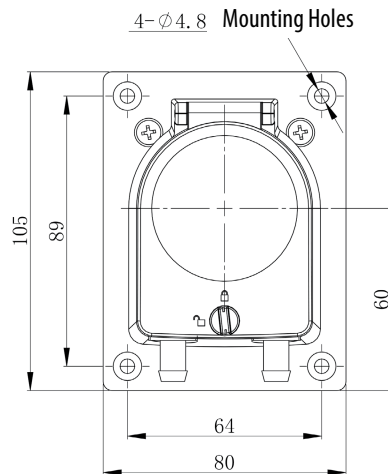

PP-202 Series

Precision Peristaltic Pump

Technical Specifications							
Model No.	Housing Material		Tubing		Speed Range (rpm)	Flow Rate (mL/min)	Weight (kg)
	Body	Protective Cover	Tubing Sizes	ID x Wall Thickness (mm)			
PP-202	PES	Transparent PC	#16	3.1 x 1.6	0.1-350	0.08~280	0.12
			#25	4.8 x 1.6		0.16~580	
			#17	6.4 x 1.6		0.30~800	

Tubing Installation Procedure

Turn the holding pin into unlocking position



Open the transparent cover



Install the tubing



Close the transparent cover, and turn the holding pin to locked position

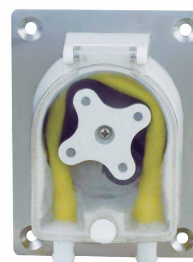



OEM PUMPS

PP-303 SERIES

FEATURES

These OEM peristaltic pumps have a compact structure and are capable of delivering up to 1330 mL/min. High grade Stepper Motors are made for long life. Our proprietary DC controller is designed to provide precise flow control.

- ✓ Flow Rate up to 1330 mL/min
- ✓ Designed for OEM applications
- ✓ High grade Stepper Motor provides long life & precise flow control
- ✓ Pumps are available with a built-in Controller/Driver for Stepper Motor



PP-303-SM-PSF



PP-303-DC-PSF

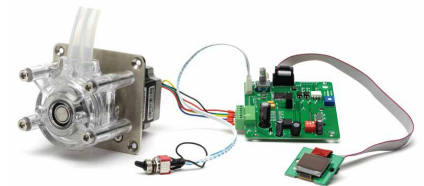

PP-303-SM-SPH-DCDR
(With Controller)

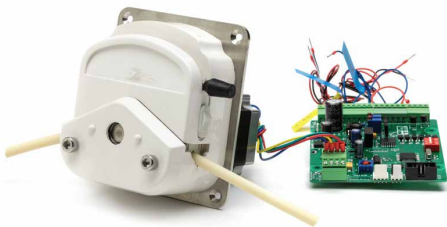

PP-303-SM-PSF-DCDR
(With Controller)

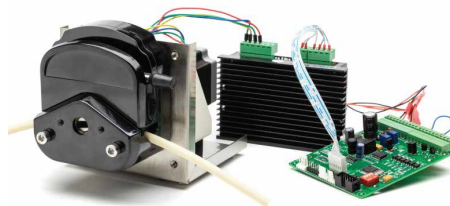

PP-303-SM-PPS-DCDR-DR
(With Controller & Driver)

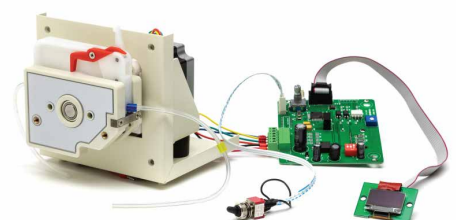

PP-303-SM-MF-DCDR
(With Controller)

PP-303 Series

Precision Peristaltic Pump

PP-303 Series Pump Details	
Speed Range	≤ 350rpm
Max. Flow Rate	1330mL/min
Motor Type	57 Stepper Motor / 42 Stepper Motor
Motor Phase Number	2
Motor Step Angle	1.8°
Motor Phase Voltage	3.75V
Motor Phase Current	3.0A

Model PP-303: Speed/Flow Rate Reference						
Pump Head	Tubing	ID x Wall Thickness (mm)	mL/r	Flow Rate (mL/min) (0.1-600rpm)	Tubing Max Pressure (Mpa)	
					Intermittent	Continuous
PSF	#13	0.8×1.6	0.07	0.007~42	0.27	0.17
	#14	1.6×1.6	0.27	0.027~162		
	#19	2.4×1.6	0.55	0.055~330		
	#16	3.1×1.6	0.82	0.082~492		
	#25	4.8×1.6	1.7	0.17~1020	0.24	0.14
	#17	6.4×1.6	2.9	0.29~1740	0.14	0.10
	#18	7.9×1.6	3.8	0.38~2280	0.10	0.07
PPS	#15	4.8×2.4	1.7	0.17~1020	0.27	0.17
	#24	6.4×2.4	2.9	0.29~1740		
SPH	#24	6.4×2.4	2.5	0.25-1500	0.27	0.17

PP-303-SM-PSF

Precision Peristaltic Pump

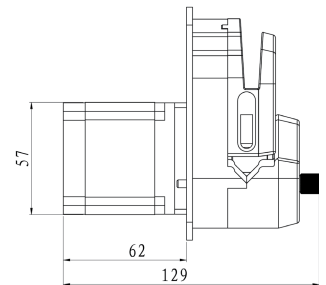
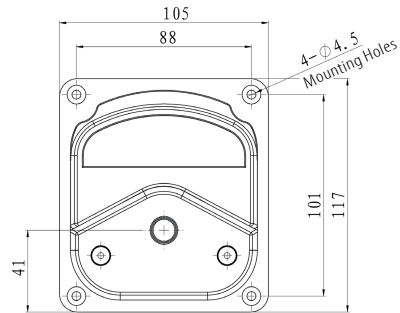

PP-303-DC-PSF

Precision Peristaltic Pump



PP-303-SM-SPH-DCDR (With Controller)

Precision Peristaltic Pump

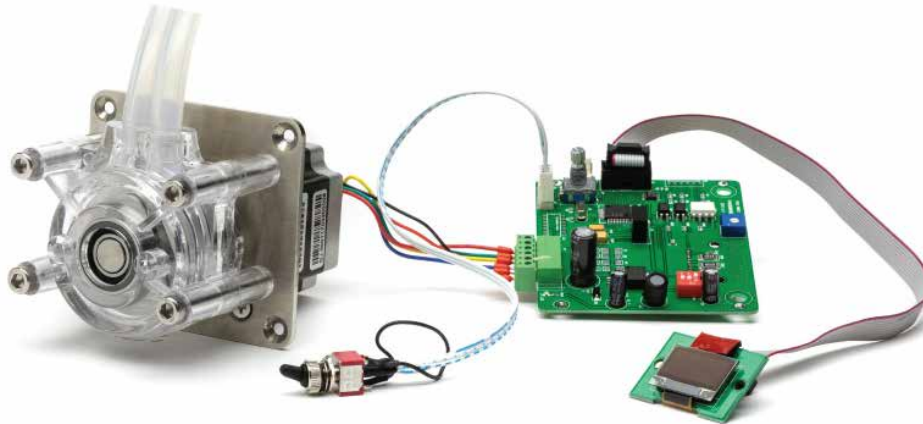

PP-303-SM-PSF-DCDR (With Controller)

Precision Peristaltic Pump

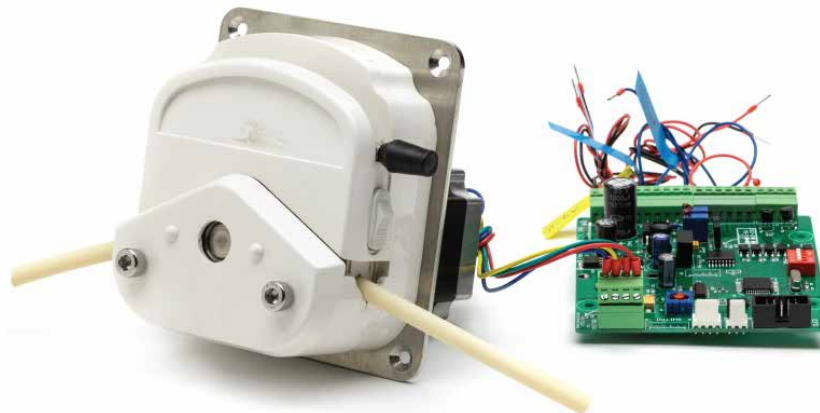

PP-303-SM-PPS-DCDR-DR (With Controller & Driver)

Precision Peristaltic Pump

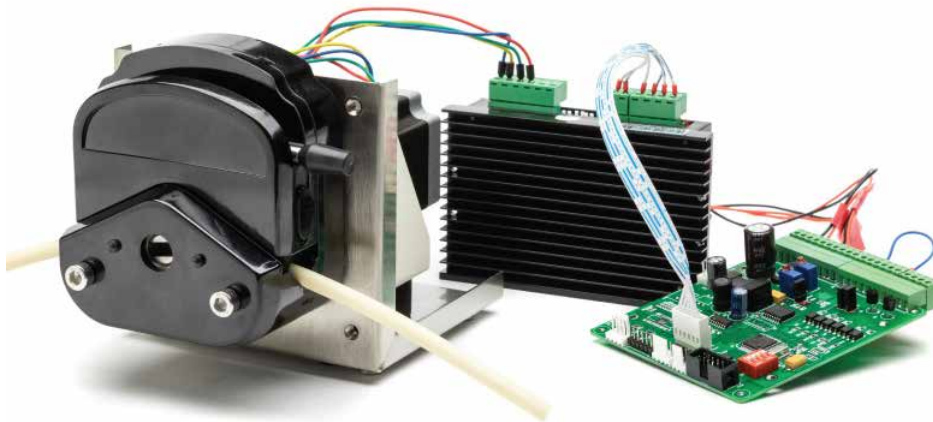

PP-303-SM-MF-DCDR (With Controller)

Precision Peristaltic Pump

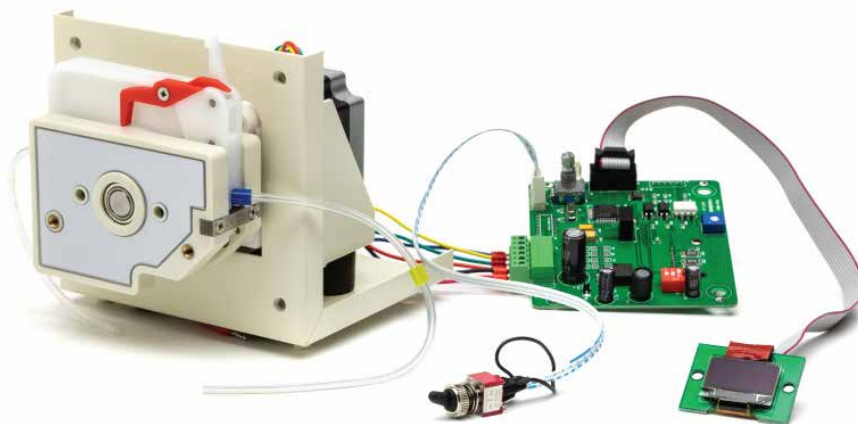

PP-404 Peristaltic Pump



TECHNICAL DETAILS

- ✓ Max. Flow Rate: 40 mL/min
- ✓ Max. Speed: 100 rpm
- ✓ Power Consumption: 12 W
- ✓ Tubing: Wall thickness 0.8 mm – 1.0 mm
- ✓ Control: Adjustable Potentiometer – 15 speeds (5-100 rpm)
- ✓ External Speed Control: 0-5 V/ 0-10 V/ 4-20 mA
- ✓ Quick tube change
- ✓ Weight: 1.1 lbs
- ✓ Dimensions: 106 mm x 60 mm x 80 mm

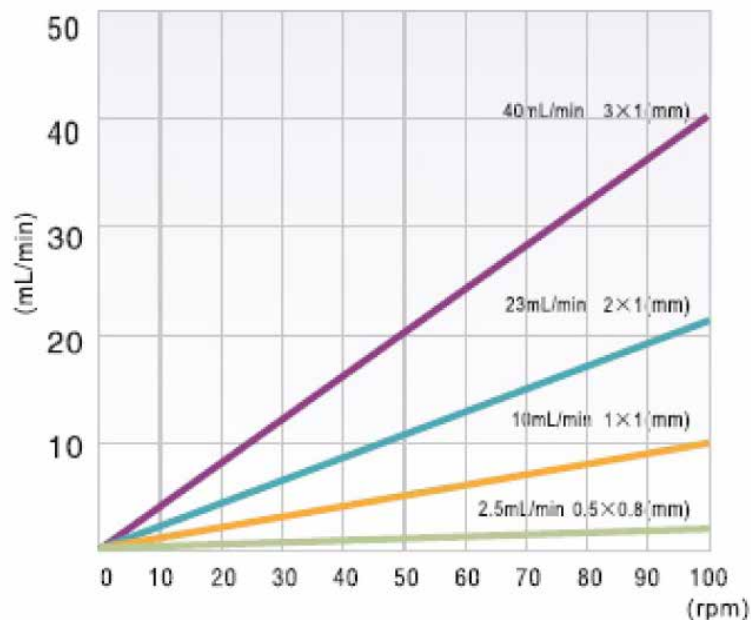
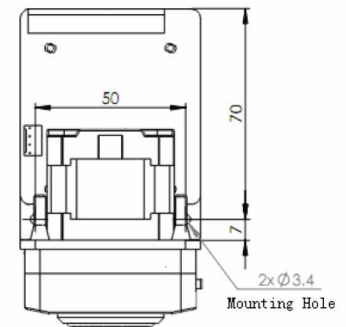
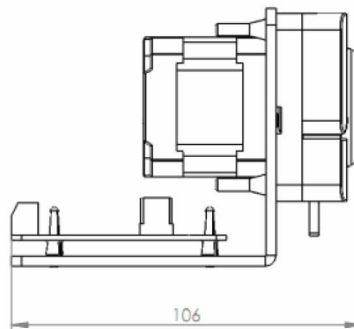
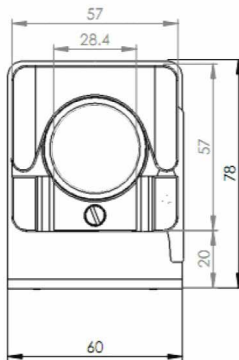



OEM PUMPS

PP-606 SERIES

FEATURES

- ✓ Quick tube change pump head
- ✓ Suitable for OEM applications including Medical equipment, Biotech & Pharmaceutical
- ✓ Twist knob used for opening & closing the pump head
- ✓ Superior tubing retention design
- ✓ Single or Dual channel
- ✓ Trouble free continuous tube easy loading. No contamination
- ✓ Easy panel mount flexibility
- ✓ Flow rate up to 365 ml/min
- ✓ 5 different tube sizes for different flow rate requirements
- ✓ High precision stepper motor with optional controller
- ✓ Small size & compact design
- ✓ Low power consumption



Single Channel



Dual Channel

Tubing Installation Procedure



PP-606 Series

Precision Peristaltic Pump

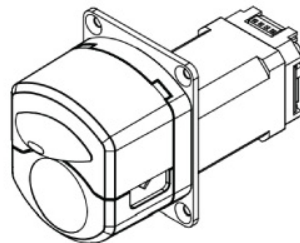
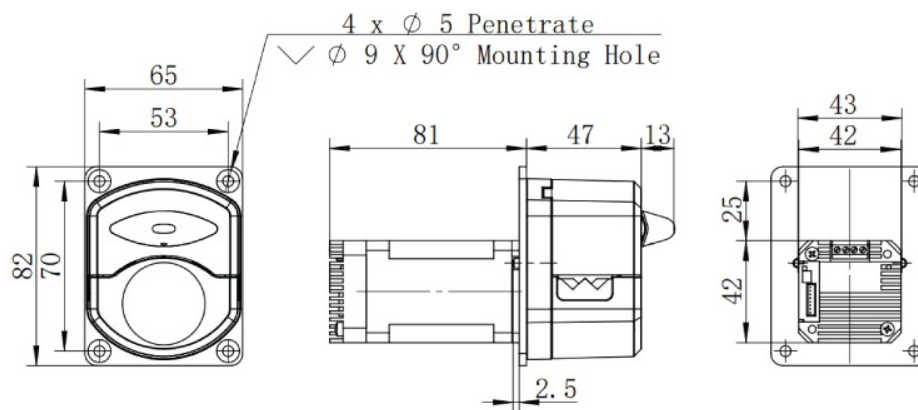

PP-606 With Controller

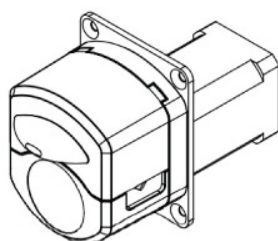
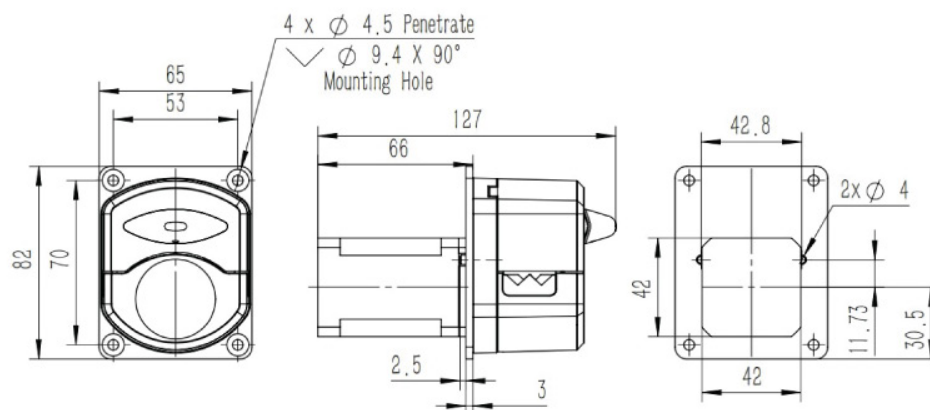

PP-606 Without Controller

PP-606 Series

Precision Peristaltic Pump

Single channel

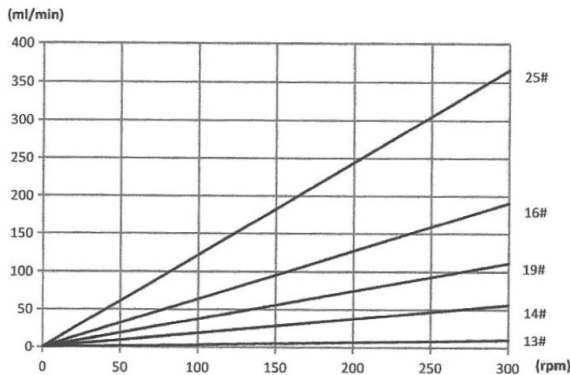

Dual channel

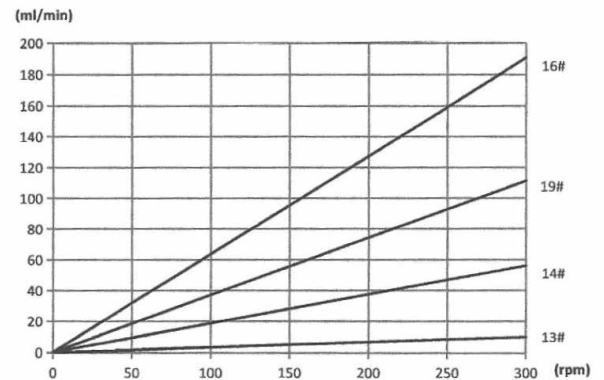

PP-606 Motor Details

Motor Voltage	24V Bipolar (4 Leads)
Step Angle	1.8°
Phase	2
Phase Current	1.0A
Phase Voltage	3.6V
Speed Range	0.1-300rpm
Condition Temperature	0-40°C
Humidity	≤ 80%RH

Technical Specifications

Pump Head	Channel Number	Tubing	ID x Wall Thickness (mm)	mL/rev	Speed (rpm)	Max Flow Rate (mL/min)
PP-606S	Single Channel	#13	0.8 x 1.6	0.033	0.1~300	10.03
		#14	1.6 x 1.6	0.187		56.09
		#19	2.4 x 1.6	0.371		111.17
		#16	3.1 x 1.6	0.636		190.76
		#25	4.8 x 1.6	1.219		365.69
PP-606D	Dual Channel	#13	0.8 x 2.4	0.033	0.1~300	10.03
		#14	1.6 x 2.4	0.187		56.09
		#19	2.4 x 2.4	0.371		111.17
		#16	3.1 x 2.4	0.636		190.76



OEM PUMPS

PP-707 SERIES

FEATURES

- ✓ Accepts continuous tubing to prevent contamination from tube connectors
- ✓ Spring loaded roller assembly ensures smooth operation
- ✓ Models available with hand crank, which can be used to pump manually in case of power failure
- ✓ Safety lock on the front cover will shut the pump off in case of opening accidentally
- ✓ Transparent front cover to help in observing the liquid flow

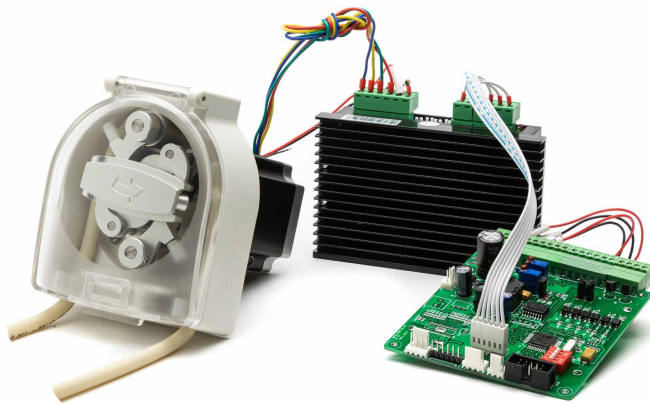

Model PP-707 has a unique design of rotor and rollers assembly. The compact design is highly desirable for OEM applications requiring high flow. Maximum flow rate is 6660 mL/min. Maximum pump speed is 600 rpm. These pumps accept 10 different tube sizes.

Models PP-707-M1 & PP-707-M2 are designed for medical devices, including Dialysis machines. These models have a spring loaded roller assembly for smooth operation and other safety features. Available with Stepper motor, DC motor & Brushless DC motor. DC Controller is available for applications requiring variable flow. These pump accept 7 different tube sizes.



PP-707 Series

Precision Peristaltic Pump

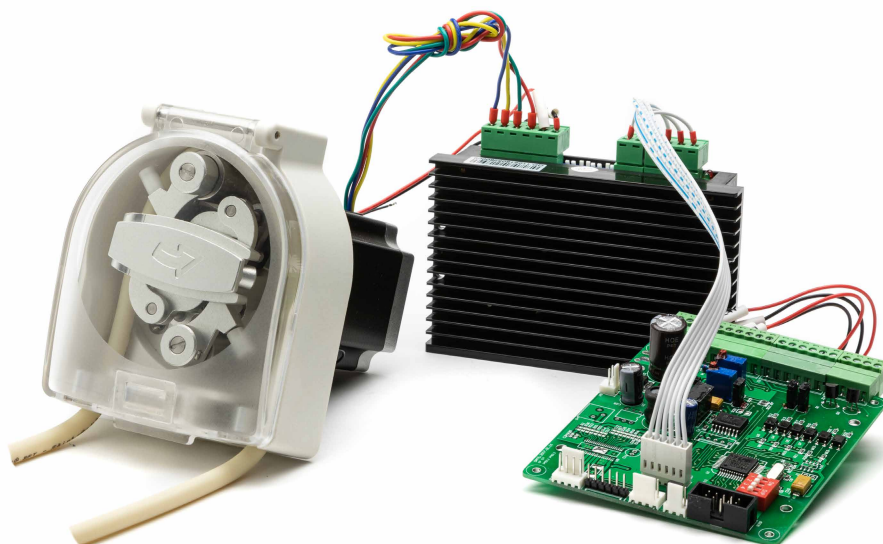

Technical Specifications					
Model No.	Roller Assembly	Tubing		Speed Range (rpm)	Flow Rate (mL/min)
		Tubing Sizes	ID x Wall Thickness (mm)		
PP-707	Non-Spring	#19	2.4 x 1.6	0.1-600	0.0875-525
		#16	3.1 x 1.6		0.1525-915
		#25	4.8 x 1.6		0.3537-2122
		#17	6.4 x 1.6		0.64488-3893
		#18	7.9 x 1.6		0.7625-4575
PP-707-1	Non-Spring	#15	4.8 x 2.4	0.1-600	0.3423-2054
		#24	6.4 x 2.4		0.5033-3020
		#35	7.9 x 2.4		0.8588-5153
		#36	9.6 x 2.4		1.1105-6663
PP-707-M1	Spring Loaded	#19	2.4 x 1.6	0.1-350	0.0875-306
		#16	3.1 x 1.6		0.1525-533
		#25	4.8 x 1.6		0.3537-1237
		#17	6.4 x 1.6		0.6488-2270
		#18	7.9 x 1.6		0.7625-2668
PP-707-M2	Spring Loaded		8 x 2	0.1-200	0.7650-1530



OEM PUMPS

PP-808 SERIES



PP-808

FEATURES

- ✓ Quick & easy tube loading pump head
- ✓ Suitable for OEM applications including Medical equipment, Biotech & Pharmaceutical
- ✓ Flip down pump head
- ✓ Superior tubing retention design
- ✓ Single channel
- ✓ Trouble free continuous tube easy loading. No contamination
- ✓ Easy panel mount flexibility
- ✓ Standard pumps are designed for 400 rpm for continuous run and intermittent use at 600 rpm
- ✓ Flow rate up to 250 mL/min (continuous run) & 495 mL/min (intermittent run)
- ✓ 5 different tube sizes for different flow rate requirements
- ✓ High precision stepper motor & optional Encoder
- ✓ 4 Rollers design for reduced pulsation
- ✓ Small size & compact design
- ✓ Low power consumption



PP-808-DC



PP-808-SP

PP-808

Precision Peristaltic Pump



PP-808



PP-808-DC



PP-808-SP

Technical Specifications						
Pump Head	Channel Number	Tubing	ID x Wall Thickness (mm)	mL/rev	Speed (rpm)	Max Flow Rate (mL/min)
PP-808	Single Channel	#13	0.8 x 1.6	0.037	0.1~600	22
		#14	1.6 x 1.6	0.135		81
		#19	2.4 x 1.6	0.285		171
		#16	3.1 x 1.6	0.450		270
		#25	4.8 x 1.6	0.825		495

Tubing Installation Procedure



PP-808

Precision Peristaltic Pump



PP-808 Motor Details

Motor Voltage	24V Bipolar (4 Leads)
Step Angle	1.8°
Phase	2
Phase Current	1.0A
Phase Voltage	3.6V
Speed Range	0.1-300rpm
Condition Temperature	0-40°C
Humidity	≤ 80%RH

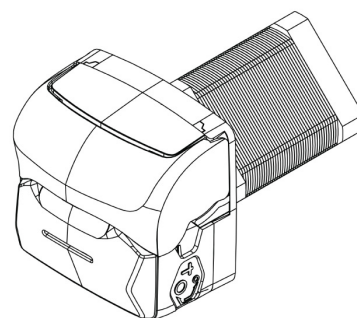
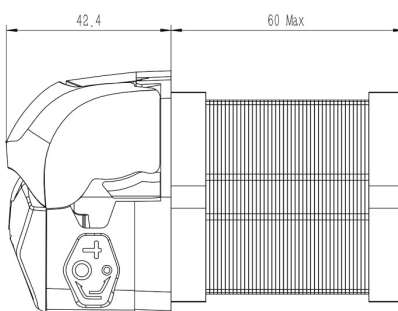
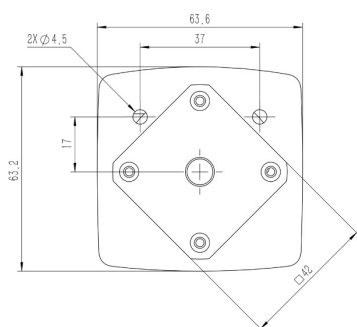

PP-808-DC (With Controller)

Precision Peristaltic Pump

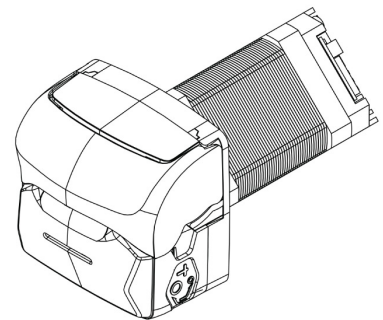
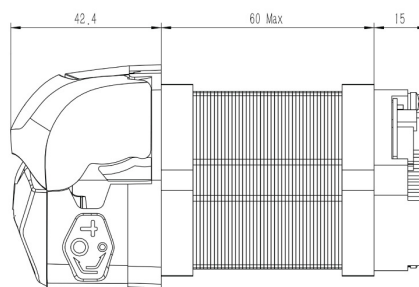
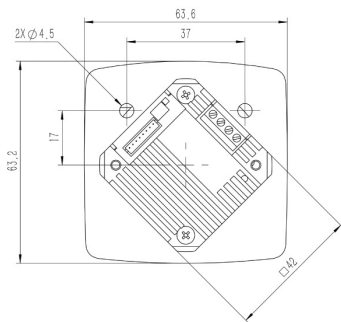

PP-808-SP

Precision Peristaltic Pump

SPECIAL ORDER

- ✓ Mini version (small motor)
- ✓ Only accepts Tube #13 and #14

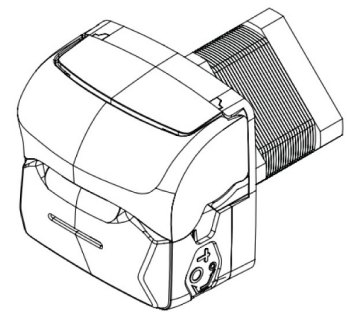
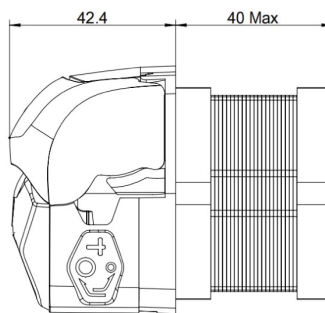
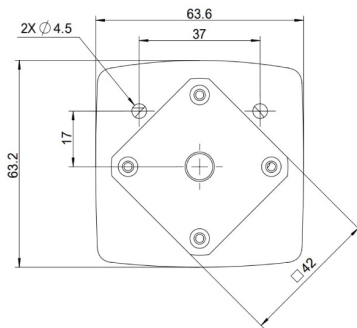

PP-909 Peristaltic Pump

TECHNICAL DETAILS

- ✓ Max. Flow Rate: 2,200 mL/min
- ✓ Max. Speed: 600 rpm
- ✓ Tubing: 1.6 mm & 2.4 mm wall thickness
- ✓ High Precision Stepper motor
- ✓ Control: External Controller available 0-5 V/
0-10 V/ 4-20 mA (Optional)
- ✓ Quick tube change
- ✓ Weight: 3 lbs.
- ✓ Dimensions: 124 mm x 105 mm x 90 mm

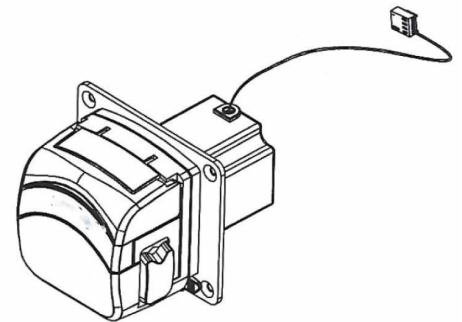
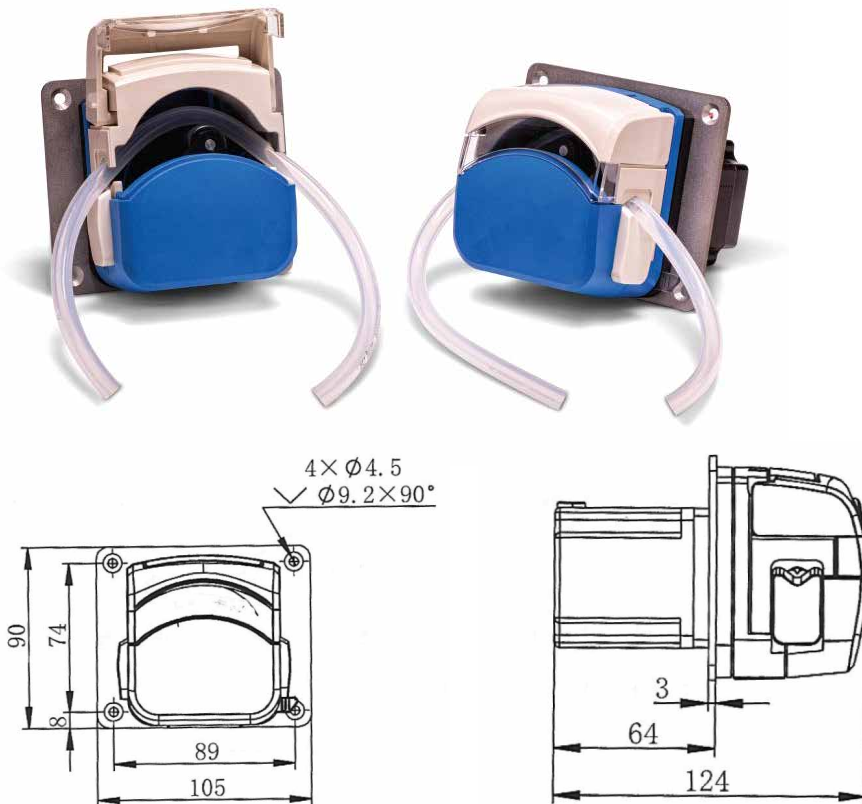

FT-1 (Tube Wall Thickness 1.6 mm)

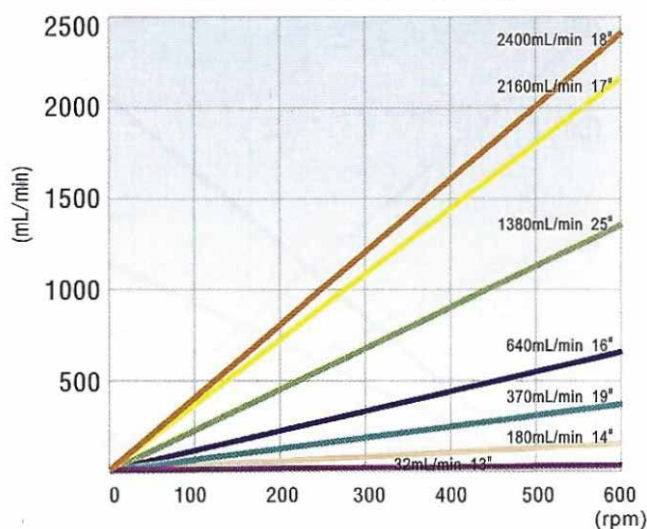

FT-2 (Tube Wall Thickness 2.4 mm)

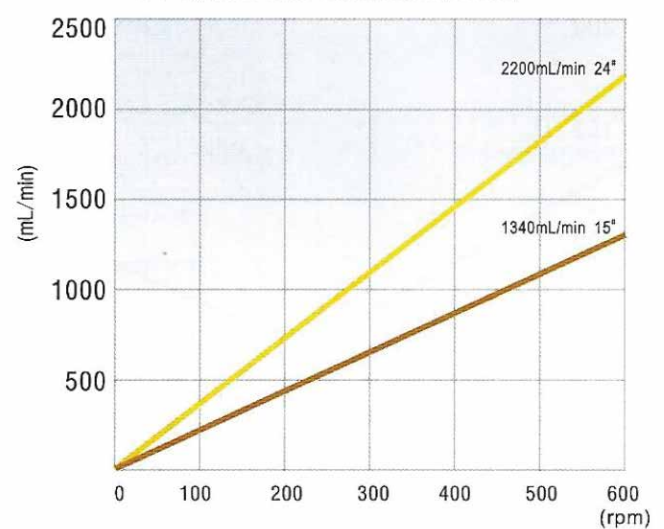

PP-909 Peristaltic Pump (continued)

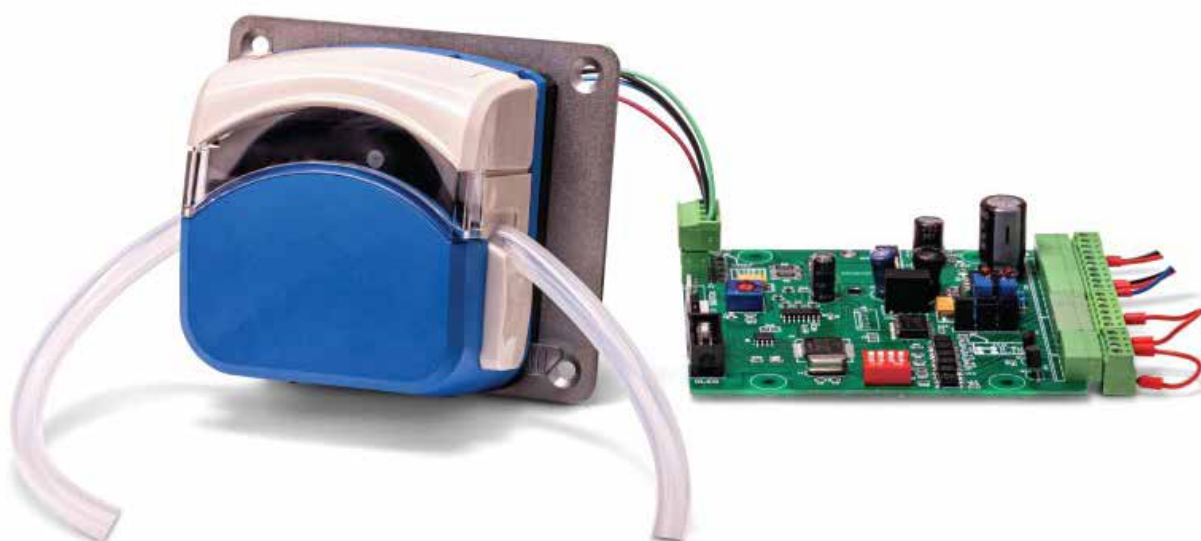

Model PP-909: Speed/Flow Rate Reference (Dual)				
Pump Head	Tubing	ID x Wall Thickness (mm)	Max Speed (rpm)	Flow Rate (mL/min)
FT-1	#13	0.8×1.6	600	36
	#14	1.6×1.6	600	160
	#19	2.4×1.6	600	360
	#16	3.1×1.6	600	640
	#25	4.8×1.6	600	1,400
	#17	6.4×1.6	600	2,200
FT-2	#15	4.8×2.4	600	1,200
	#24	6.4×2.4	600	2,000