

PP-909 Peristaltic Pump

TECHNICAL DETAILS

- ✔ Max. Flow Rate: 2,200 mL/min
- ✔ Max. Speed: 600 rpm
- ✔ Tubing: 1.6 mm & 2.4 mm wall thickness
- ✔ High Precision Stepper motor
- ✔ Control: External Controller available 0-5 V/ 0-10 V/ 4-20 mA (Optional)
- ✔ Quick tube change
- ✔ Weight: 3 lbs.
- ✔ Dimensions: 124 mm x 105 mm x 90 mm

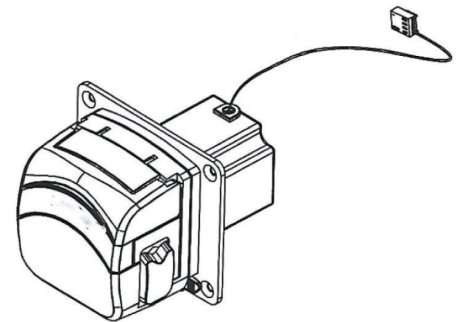
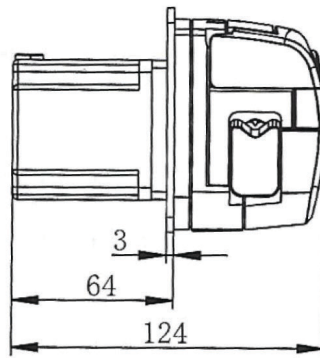
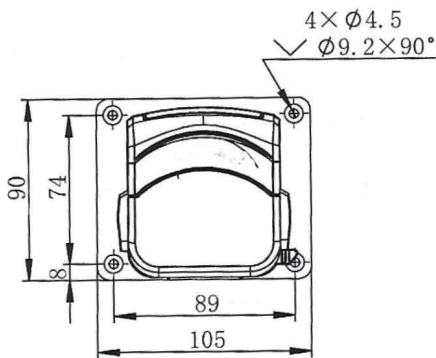

FT-1 (Tube Wall Thickness 1.6 mm)

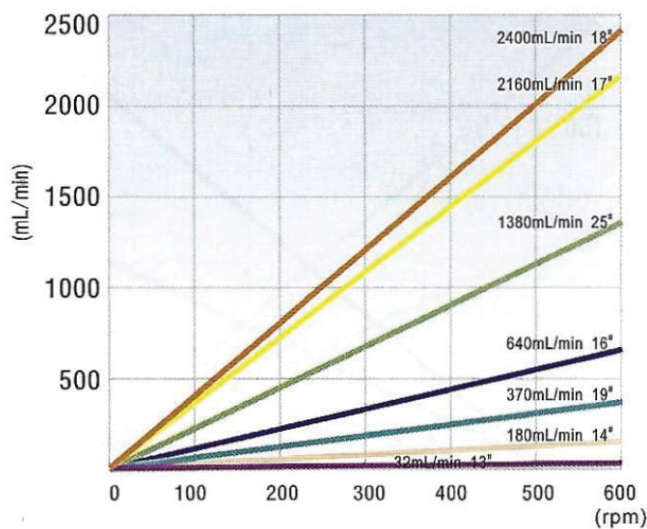

FT-2 (Tube Wall Thickness 2.4 mm)

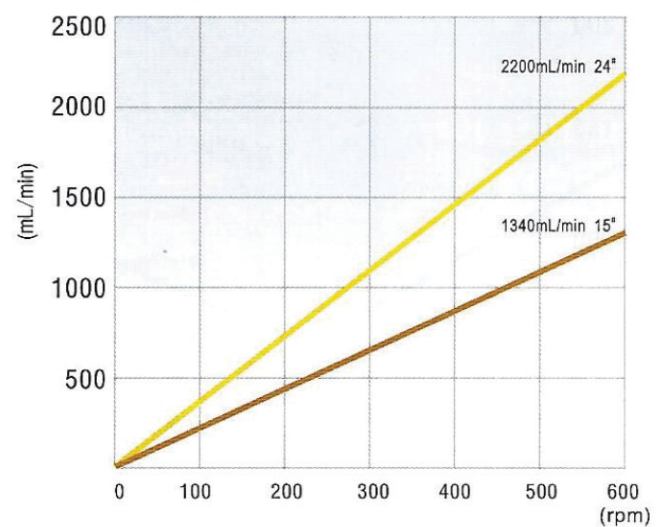

PP-909 Peristaltic Pump (continued)

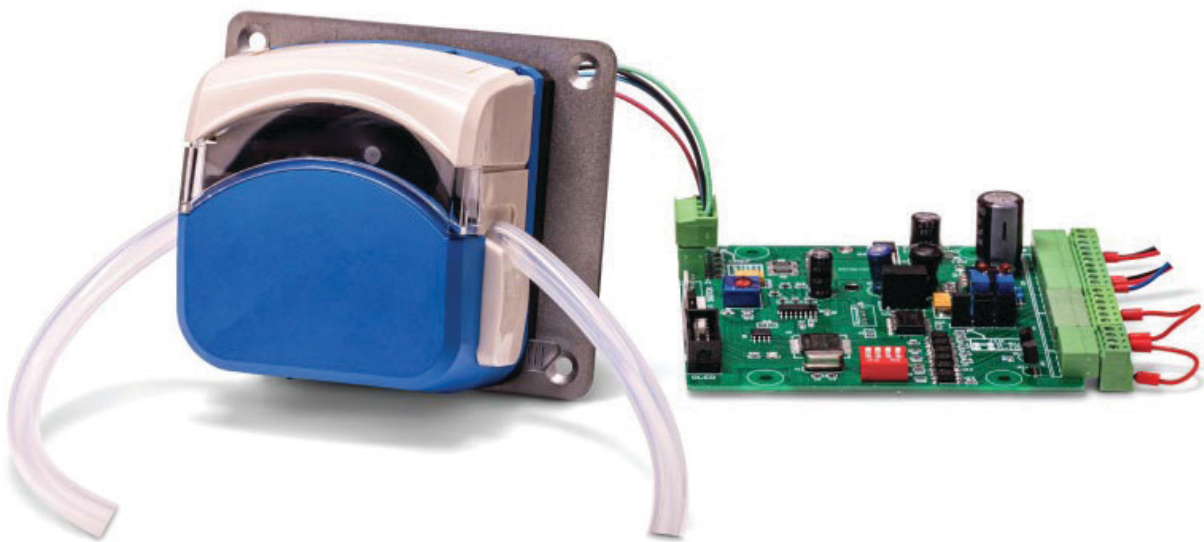

Model PP-909: Speed/Flow Rate Reference (Dual)				
Pump Head	Tubing	ID x Wall Thickness (mm)	Max Speed (rpm)	Flow Rate (mL/min)
FT-1	#13	0.8x1.6	600	36
	#14	1.6x1.6	600	160
	#19	2.4x1.6	600	360
	#16	3.1x1.6	600	640
	#25	4.8x1.6	600	1,400
	#17	6.4x1.6	600	2,200
FT-2	#15	4.8x2.4	600	1,200
	#24	6.4x2.4	600	2,000