

PP-9 Peristaltic Pump

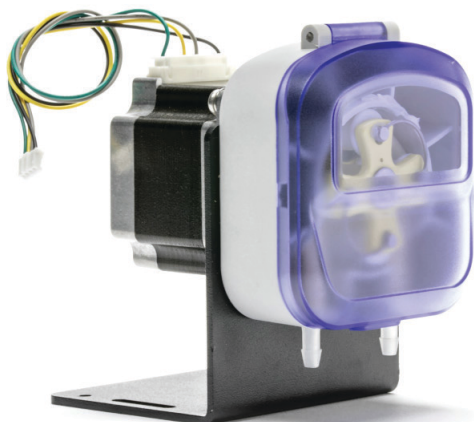

FEATURES

- ✓ Designed for higher flow applications
- ✓ Flow Rate: up to 300 mL/min
- ✓ Suitable for viscous and non-viscous liquids, as well as handling liquids with particles
- ✓ Choice of DC Motor or Stepper Motor for precise control (see PP-8 for DC Motor option)
- ✓ Thick wall tubing for long life and tubing materials provide for good chemical resistance
- ✓ Tubing Options: PharMed® BPT (BPT) and Norprene® (N)
- ✓ 4 rollers for higher precision (Optional)

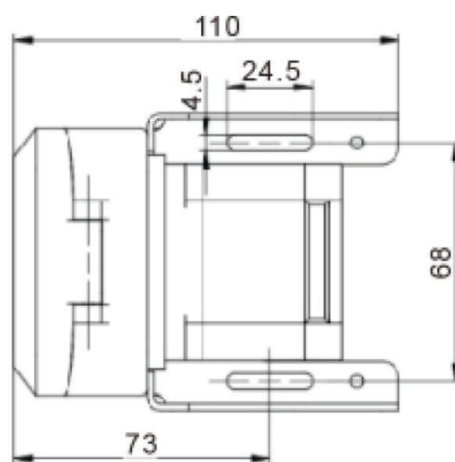
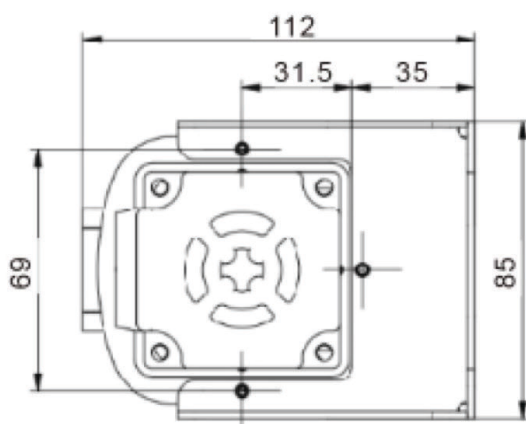

PP-9	Flow Rate (mL/min)		Speed (RPM)	Weight (lbs.)
Stepper Motor 12 VDC (1.8 A)	5-300 (400 RPM)	5-300 (400 RPM)	1-500	3.2
Stepper Motor 24 VDC (0.9 A)	5-300 (400 RPM)	5-300 (400 RPM)	1-500	3.2
Tubing Options				
Tubing Material	BPT	Norprene	---	---
Tubing Size IDxOD (mm)	4x7.2	4x7.2	---	---